

User Manual



For terms and conditions please visit: mimi-moto.com/terms

version: 09-2016

Notes	5
Assembly of feet and pan support	6
How to use with wood sticks	7
Lighting and extinguish the stove	8
To continue cooking when only glowing embers are left	10
What if the stove is producing a lot of smoke?	11
Stoves without battery pack	12
Stoves with built-in battery pack	13
Warnings	14

Components

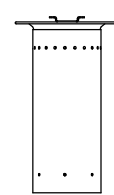
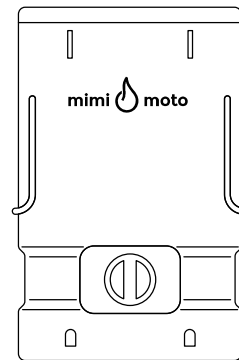

small burner

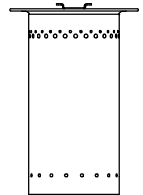

large burner



5 feet



5 pan supports



burner handle

OPTIONAL



USB cable



power adapter

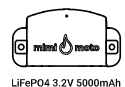

battery pack

Notes

Assembly of feet and pan support

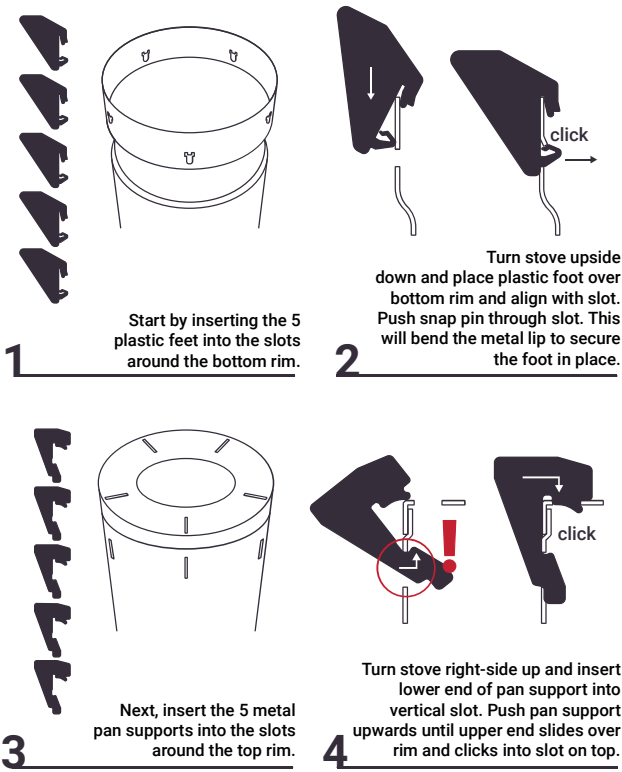

How to use with wood sticks

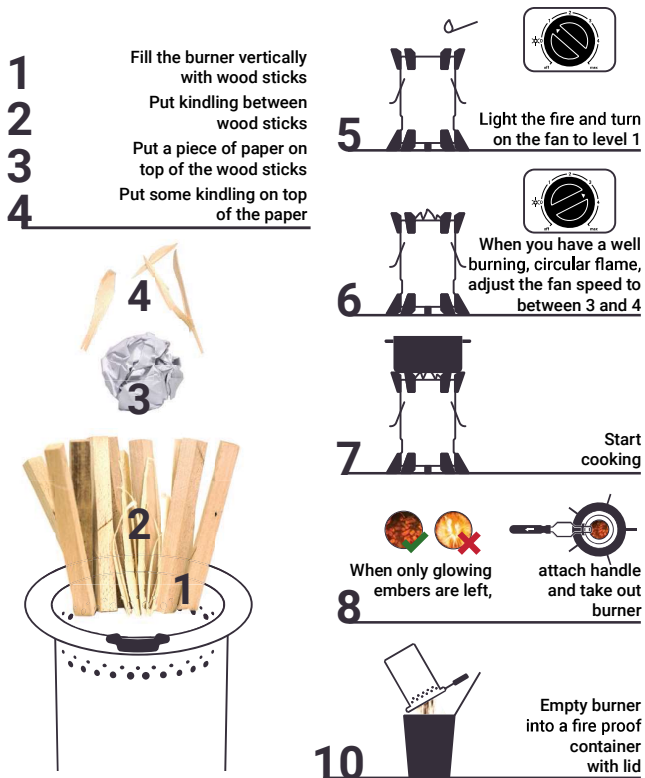

How to Light and extinguish the stove

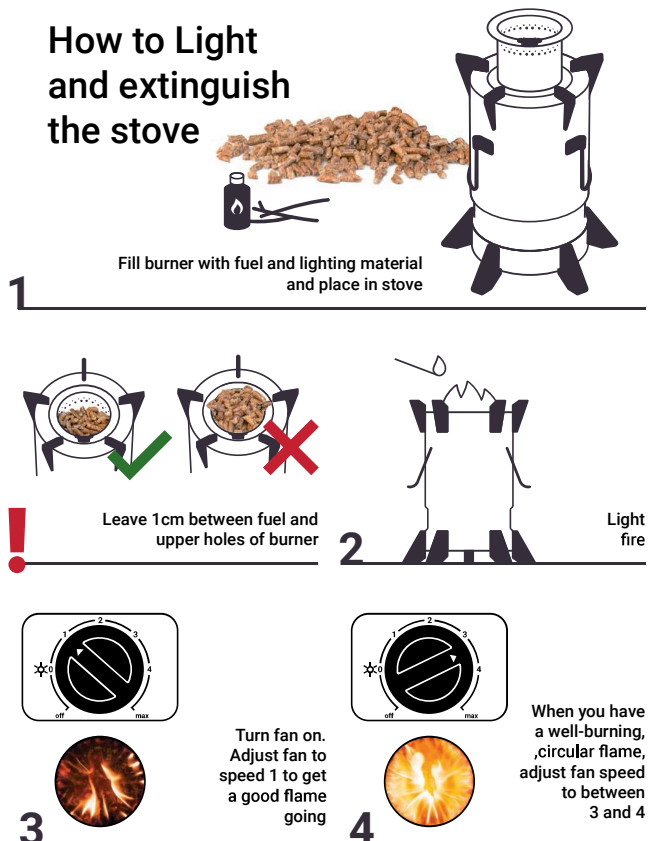

Attention: We recommend that you DO NOT run the fan at it's highest speed!

Maximum fan speed will increase the intensity of airflow, resulting in:

- short battery life
- inefficient flame
- inefficient pellets use
- more pollution

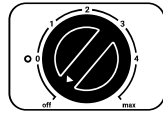
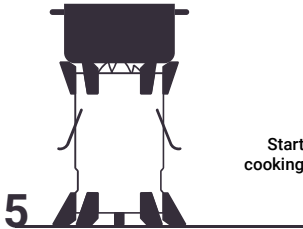
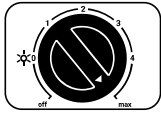

Use stove until all flames have extinguished and only glowing embers are left

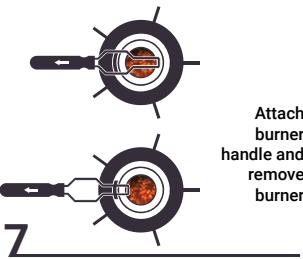

Attach burner handle and remove burner

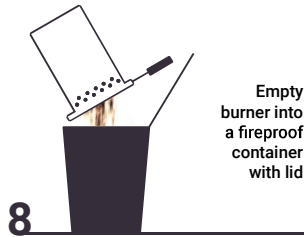

Empty burner into a fireproof container with lid

To continue cooking when only glowing embers are left



Attach burner handle to burner, and remove it from stove.

Place it somewhere safe



Place second burner in stove

Fill second burner with fuel up to 1cm below upper holes



Use burner handle to empty first burner into second burner

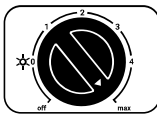

Turn up fan speed until flames appear from upper holes

Regulate flames by adjusting fan speed, and continue cooking

What if the stove is producing a lot of smoke?

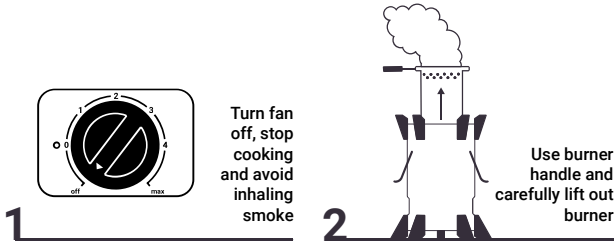

Turn fan off, stop cooking and avoid inhaling smoke

Use burner handle and carefully lift out burner



Place burner outdoors, or empty burner into a fireproof container with lid and place outdoors

Stoves WITHOUT battery pack

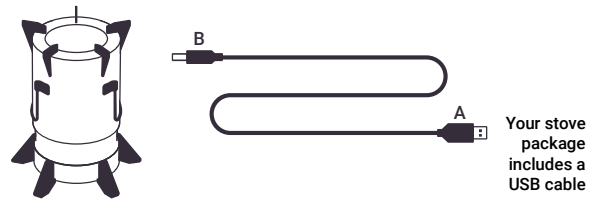

Your stove package includes a USB cable

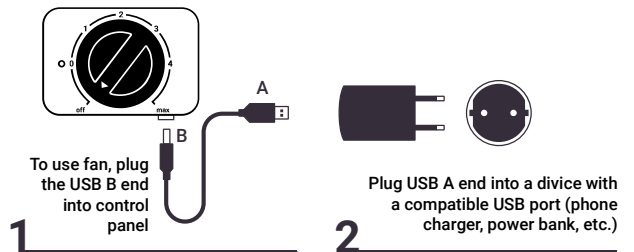

To use fan, plug the USB B end into control panel

Plug USB A end into a device with a compatible USB port (phone charger, power bank, etc.)

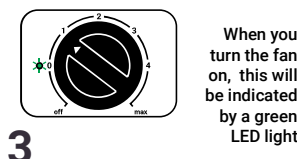

When you turn the fan on, this will be indicated by a green LED light

Stoves WITH built-in battery pack

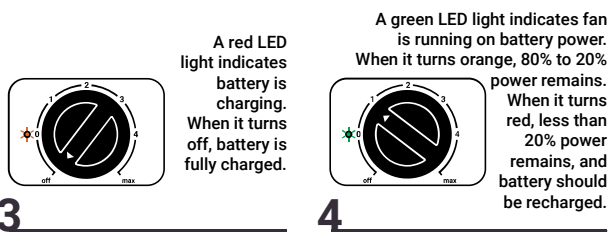
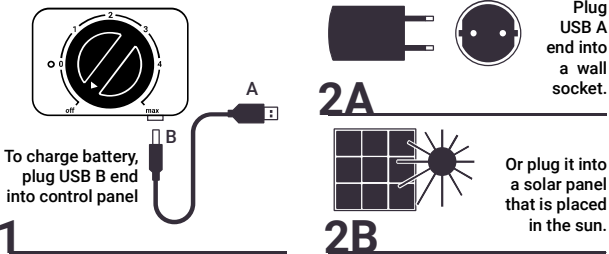
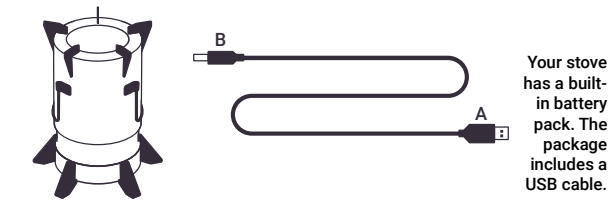

Warnings

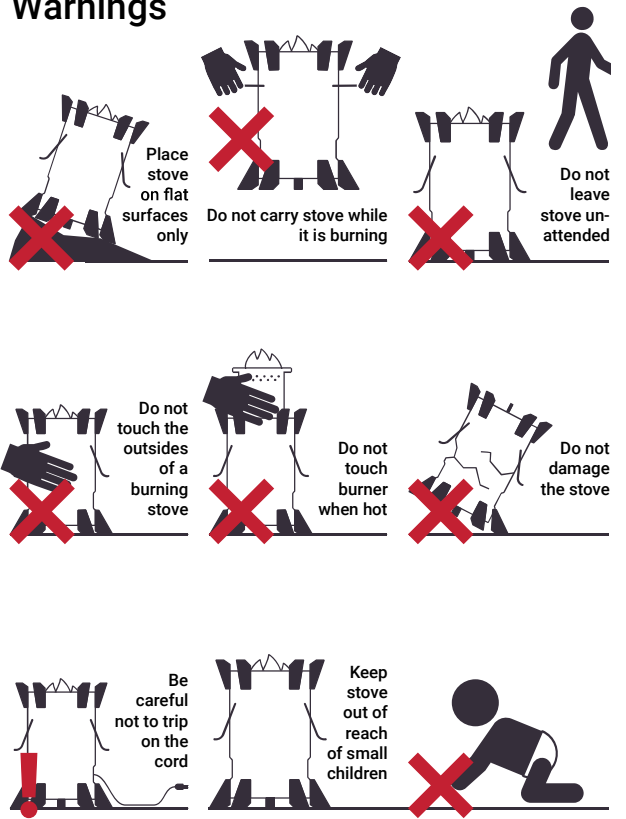

Warnings

